

DRILL PIPE:

PAT water well drilling drill pipe is manufactured entirely in the PAT Factory - Threaded tool joints are CNC machined and gauged to API thread standards to ensure high accuracy and consistency throughout drill pipe batches. Both the high tensile seamless steel tube and tool joint material are bought directly from steel mills with material compliance certification.

Tool joints are joined to drill pipe bodies using the "Inertia" or "Friction" CNC controlled welding machines PAT have in the factory.

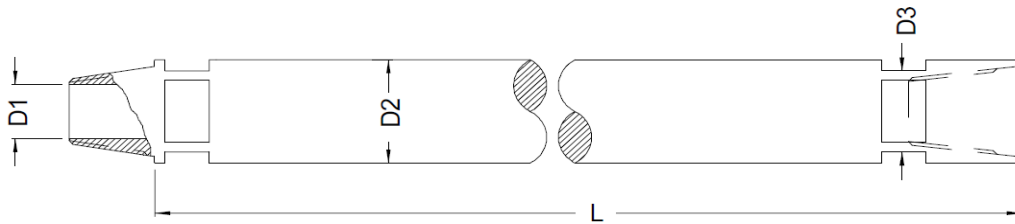

| Part number | Reference | Description | L meter | D1 (mm) | D2 (mm) | D3 (mm) | Weight Kg |
|-------------|----------------|---|------------|------------|------------|------------|--------------|
| 30 5 1000 | 301, option | DRILL PIPE 60 MM, 2.0 M LONG | 2.0 | 28 | 60 | 50 | 12.4 |
| 40 5 1000 | 301, 301T, 421 | DRILL PIPE 76 MM, 2.0 M LONG, 2 3/8 REG MOD | 2.0 | 40 | 76 | 60 | 18.2 |
| 42 5 1000 | 421 | DRILL PIPE 89 MM, 2.0 M LONG, 2 7/8 REG MOD | 2.0 | 46 | 89 | 70 | 19.9 |
| 50 5 1000 | 431, 431T | DRILL PIPE 76 MM, 3.0 M LONG, 2 3/8 REG MOD | 3.0 | 40 | 76 | 60 | 26.6 |
| 60 5 1000 | 431T, 501, 601 | DRILL PIPE 89 MM, 3.0 M LONG, 2 7/8 REG MOD | 3.0 | 42 | 89 | 70 | 32.4 |
| 61 5 1000 | option | DRILL PIPE 89 MM, 3.0 M LONG, 2 7/8 IF MOD | 3.0 | 44 | 89 | 70 | 34.2 |
| 80 5 2000 | 701, 801 | DRILL PIPE 100 MM, 6.0 M LONG, 3 REG MOD | 6.0 | 50 | 106.6 | 80 | 95.4 |

Drill pipe tube is a seamless drawn grade ST52-3 and tool joints are machined from SCM 440 grade. Tool joints. Tool joints are fuse welded to the drill tube by CNC controlled inertia welding process.