

BOREHOLE DEVELOPMENT COMPRESSOR SET

Part no 30 4 0880

Piston Compressor Driven by Diesel / Petrol Engine

A dedicated borehole development compressor can be used in place of the main drilling compressor in order to free up the main compressor and drilling rig, for move on to the next drilling site. PAT offers a borehole development compressor with a flexible hose system on a steel reel and stand.

Borehole development compressor is mounted on a steel skid, powered by a small engine, and mechanically driven by 2 V-Belts with attached safety guard.

The flexible rubber hose system with an attached development probe, which is all mounted on a combined steel reel and stand.

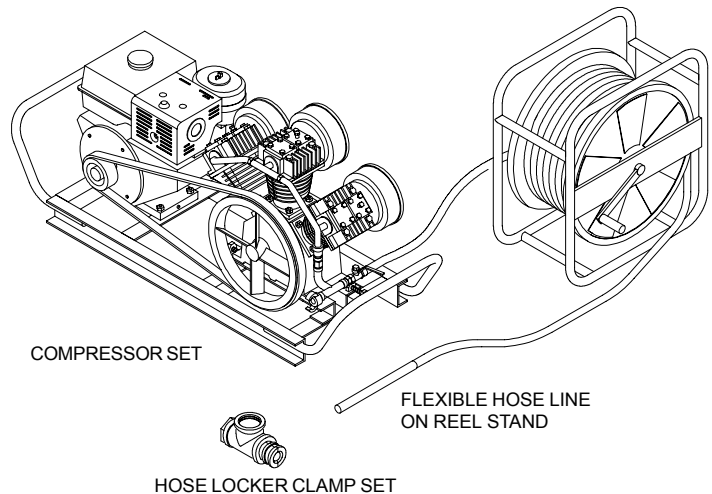

Technical Specifications

Borehole Development Compressor

Engine Type:	10 HP YANMAR diesel engine, hand starting, 3600 rpm, air-cooled (13 HP HONDA petrol engine available)
Compressor Type:	3 cylinder piston compressor
Displacement :	27.1 cfm
Max. pressure :	10 bar
Net Weight :	Skid unit, 146 kg (diesel), 128 kg (petrol)
Shipping Data :	GW: 176 kg (diesel), 154 kg (petrol) DIM: 57x130x71 cm

Flexible Hose Line System

Hose :	1/2 inch x 5 metres flexible rubber hose with connections from reel stand to borehole development compressor 1/2 inch x 50 metres (Optional 80 metres) flexible rubber hose with connections and attached an air probe
Reel and Stand :	Tubular steel frame with detachable steel handle for rolling up and storing the hose line after well development
Shipping Data :	NW: 54 kg (50 m), 84 kg (80 m) GW: 76 kg (50 m), 108 kg (80 m) DIM: 52 x 70 x 76 cm (50 m), 63 x 70 x 76 cm (80 m)